



FLÛTE

# FLÛTE

Lucci / Orlandini design

Flûte, collezione altamente direzionale, disegnata dagli Arch. Lucci e Orlandini, rivisitata, in chiave moderna, armonia di forme e materiali propri dell'high-life degli anni '50. Nostalgico il design, ma all'avanguardia i concetti di modularità, intercambiabilità, elettrificazione e accessoristica. Le finiture sono mogano honduras, noce biondo e ebano.

Finitions acajou Honduras, noyer clair et ebène. The new and high directional Flute collection, designed by architects Lucci & Orlandini, interprets the high life style of the fifties. The design is nostalgic but the concepts of modularity, interchange ability, electrification and fittings are extremely technological. The finishes are in Honduras mahogany, light walnut and ebony.

Flûte, la nouvelle collection de haute direction dessinée par les architectes Lucci et Orlandini, évoque en clé moderne l'harmonie des formes et des matériaux de l'high-life des années '50. Mais si le design a la nostalgie du passé, sa réalisation technique, la modularité, l'interchangeabilité des meubles de complément, le système d'électrification et les accessoires sont à l'avantgarde.







La preziosità di un arredo è rivelata dall'attenzione posta nel design evidenziandosi anche attraverso la cura dei particolari, la scelta degli accessori e l'inserimento di sottomanili in cuoio. Le paratie vengono proposte in cuoio, un contrasto di materiali che esalta e scandisce la purezza e la leggerezza di linee della scrivania.

The elegance of a furniture is highlighted by the unique design, the care for details, the choice of its accessories and the leather desktop inserts. Modesty panels are offered in leather. This contrast of materials enhances the purity and lightness of the desk's lines.

Le prestige d'un espace se révèle aussi dans le design, dans le soin des détails, le choix des accessoires et pour sousman en cuir. Les séparations sont proposées en cuir, un contraste de matériaux qui exalte et rythme la pureté et la légèreté des lignes des bureaux.





Il posto di lavoro in versione noce chiaro consente altresì flessibilità e massima componibilità nella purezza delle sue linee.

Ebano, cuoio, cristallo e cromo: materiali di alto pregio sapientemente coniugati tra di loro conferiscono a questa collezione un autentico status di classe e raffinata eleganza. Il succedersi di linee curve, ora rientranti, ora bombate, viene riproposto anche nei mobili di complemento.

The workplace in light walnut, with its pure lines, grants both flexibility and maximum modularity.

Ebony, leather, glass and chrome: precious materials wisely matched that give this collection a top class image of a refined elegance. The curved outlines sequence, at times hollowed or convex, is also offered in the complementary furniture.

Le poste de travail en noyer clair, permet une grande flexibilité et une grande modularité dans l'élégance et la beauté de ses lignes.

Ebène, cuir, verre et chrome: matériels de haute valeur sagement alliés entre eux et qui donnent à cette gamme une image de classe authentique et d'élégance raffinée. La géométrie variable des lignes courbes, tantôt concaves tantôt convexes, est reprise dans les meubles de complément.





Modernissimi nella loro classicità, i tavoli riunione, anch'essi componibili, conservano il motivo della canalizzazione centrale elettrificata porta oggetti.

Extremely modern notwithstanding its classical style, the modular meeting tables are fitted with a central cable management support with a space also for housing objects.

Très modernes dans leur ligne classique, les tables conférence sont composables aussi, et l'on y retrouve la canalisation centrale électrifiée porte-objet.









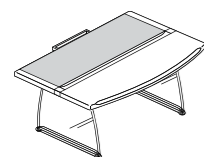

UTEC160/P UTEC190/P  
UTEC210/P  
L 160 | P 110 | H 73  
L 190 | P 110 | H 73  
L 210 | P 110 | H 73

**Scrivania lato stondato con  
sottomano in cuoio**  
Desk with one rounded frontal side  
and leather inlay  
Bureau courbe avec sousmain en cuir

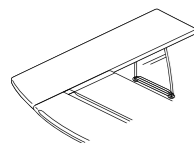

UTE/ALL200  
L 200 | P 55 | H 73

**Allungo**  
Side extension  
Retour

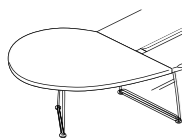

UTE/GC115  
L 100 | ø115

**Allungo a goccia**  
Drop-shaped extension  
Retour convivialité

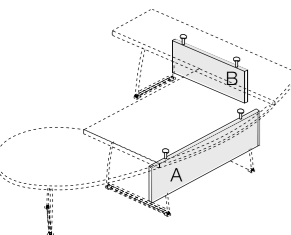

UTEPA  
L 160 190 210 | H 36  
L 160 190 210 | H 55

UTEBAL  
L 90 | H 36  
L 90 | H 55

**Paratia rivestita in cuoio**  
Modesty panel covered in leather  
Voile de fond couverte en cuir

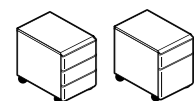

UTE/RC3 UTE/RC2  
L 42,5 | P 60 | H 57

**Cassettiera su ruote in legno con  
top in cuoio**  
Wooden mobile pedestal with  
leather top  
Caisson sur roulettes en bois avec  
top en cuir

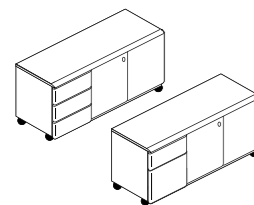

UTE/120/3M  
UTE/120/2M  
L 120 | P 45 | H 54  
L 120 | P 45 | H 54

**Mobile di servizio su ruote in  
legno con top in cuoio**  
Wooden complement return on  
castors with leather top  
Meuble de service sur roulettes  
en bois avec top en cuir

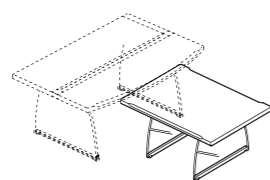

UTETA/13  
L 130 | P 90 | H 68

**Tavolo appoggio  
per scrivania**  
Briefing table for desk  
Convivialité pour bureau



UTE/TC130  
ø130

**Tavolo conferenza**  
Conference table  
Table réunion

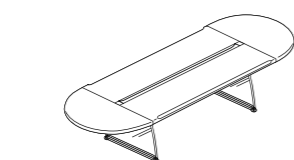

UTE/TC290  
UTE/TC320  
UTE/TC340  
L 290 | P 130 | H 73  
L 320 | P 130 | H 73  
L 340 | P 130 | H 73

**Tavolo conferenza**  
Conference table  
Table réunion

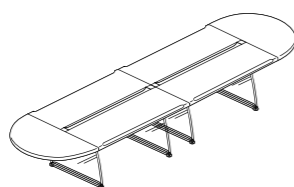

UTE/TC450  
UTE/TC510  
UTE/TC550  
L 450 | P 130 | H 73  
L 510 | P 130 | H 73  
L 550 | P 130 | H 73

**Tavolo conferenza**  
Conference table  
Table réunion

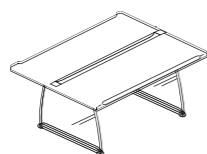

UTE/TC160I  
UTE/TC190I  
UTE/TC210I  
L 160 | P 130 | H 73  
L 190 | P 130 | H 73  
L 210 | P 130 | H 73

**Tavolo conferenza**  
Conference table  
Table réunion

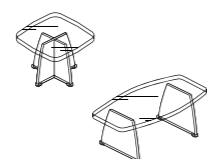

UTE/TB70  
UTE/TB120  
L 70 | P 70 | H 42  
L 120 | P 60 | H 42

**Tavoli bassi**  
Low tables  
Tables basses





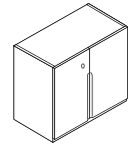

UTE/LB72  
L 80 | P 45 | H 73

Libreria bassa senza top  
Low cupboard without top  
Meuble bas sans top

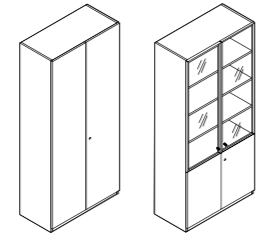

M22 M23K  
L 90 | P 45 | H 200  
L 90 | P 45 | H 200

Armadi h.200  
Bookcases h.200  
Armoires h.200

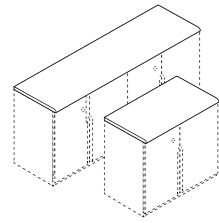

UTE/TOP80  
UTE/TOP160  
L 80 | P 45  
L 160 | P 45

Tops per LB72 in legno  
Finishing tops for LB72  
Tops de finition pour LB72

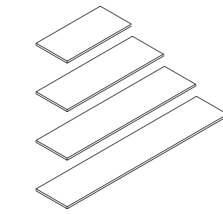

TOPOY/90 TOPOY/180  
TOPOY/225 TOPOY/270  
L 90 180 225 270 | P 45

Top in legno postformato per M  
Post formed finishing tops for M  
Tops de finition postformé pour M

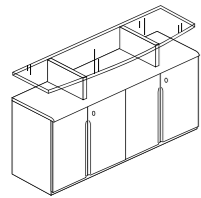

UTE/CR160  
L 160 | P 50 | H 97

Credenze  
Bookcases  
Bahuts

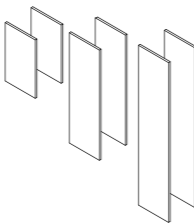

F07 F13 F20  
H 73  
H 138  
H 200

Fianchi in legno postformato per M  
Post formed finishing lateral side for M  
Finitions latérales postformé pour M

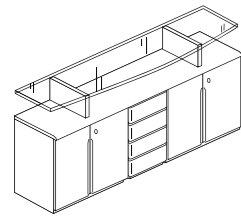

UTE/CR210  
L 210 | P 50 | H 97

Credenze  
Bookcases  
Bahuts

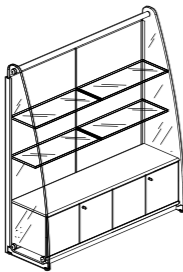

UTE/LB1802A  
UTE/LB1802C  
L 184 | P 54 | H 200

Libreria in cristallo da cm. L184  
Glass bookcase cm. L184  
Bibliothèque cm. 184 en verre

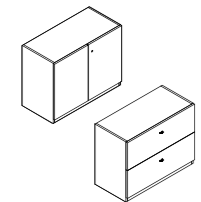

M2 M3  
L 90 | P 45 | H 72  
L 90 | P 45 | H 72

Libreria bassa h.72  
Low cupboard  
Meuble bas

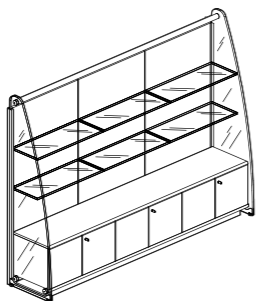

UTE/LB2703A  
UTE/LB2702A+1C  
L 274 | P 54 | H 200

Libreria in cristallo da cm. L 274  
Glass bookcase cm. L274  
Bibliothèque cm. L274 en verre

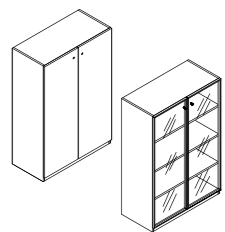

M12 M13K  
L 90 | P 45 | H 138  
L 90 | P 45 | H 138

Armadi h.138  
Cupboards h.138  
Armoires h.138

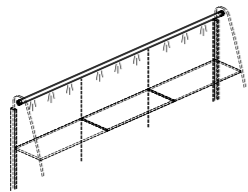

UTE/LB1812  
L 184 | P 54 | H 200

UTE/LB2712A  
L 274 | P 54 | H 200

Illuminazione superiore  
a lampade fluorescenti per  
UTE/LB180 e per UTE/LB270  
Fluorescent lamps lighting for  
UTE/LB180 and for UTE/LB270  
Éclairage supérieur à lampes fluorescentes  
pour UTE/LB180 et pour UTE/LB270





Finiture  
Finishings  
Finition



EB  
ebano  
ebony  
ébène



WN  
noce chiaro  
light walnut  
noyer clair



WM  
mogano honduras  
mahogany honduras  
acajou honduras

Finiture  
Finishings  
Finitions

Le pregiate essenze di ebano, mogano e noce, conferiscono naturalezza ed eleganza.  
I materiali della struttura e degli accessori si legano con i legni in modo equilibrato ed armonico: il cuoio impunturato, gli elementi in pressofusione spazzolato lucido ed il cristallo trasparente esaltano ed enfatizzano la ricchezza delle essenze lignee.

The use of precious woods such as ebony, mahogany and walnut, water veneered to an opaque finish, result in natural elegance. The materials used for the structure and accessories mix with the woods in a balanced and harmonious way: the stitched leather, the brush polished die cast elements and the transparent tempered glass, enhance the beauty and elegance of the wood elements.

Les précieux bois d'ébène, acajou et noyer, laqués à l'eau avec finition à pore ouvert et opacité prononcée, donnent naturel et élégance.  
Les matériels de la structure et des accessoires se mélangent avec les bois de façon équilibré et harmonique: le cuir maillé, les éléments en sous pression de l'aluminium poli, et le verre transparent vantent la richesse des éléments en bois.

Base  
Base feet  
Piètement



CV  
Base cristallo  
Crystal base feet  
Piètement en cristal



